



WAYS TO REACH ANSELL BRUSSELS OFFICE

There are several possible options:

- 1) Free shuttle service
 - 2) Public transport (by bus):
STIB 78, 98 – De Lijn 153, 154, 155, 810
 - 3) Personal car with parking facilities
 - 4) Bike
-

1) Free Shuttle

Arriving at the Brussels South Station, you will walk to the exit '**Rue de France**' (next to 'Galerie Horta').

When exiting onto Rue de France, keep on the side of the train station until you get to a bus stop in front of the Infrabel building.

The bus will either be waiting / departing from this spot, or a bit further down the street depending on traffic and parking availability.

Busses are marked GILLES (or white bus without a name) going to the Riverside Business Park.

This service is free of charge as this is services paid by the companies based in the Business Park. The bus stops in front of our offices at the bus plate between building E and building H.

The bus comes three times in the morning and in the evening.

The bus will leave the appointment place at the following hours:

From the South station to Ansell: 7h40, 8h20, 9h00

From Ansell to the South station: 16h00, 16h35, 17h05, 17h40.

No identification is asked.

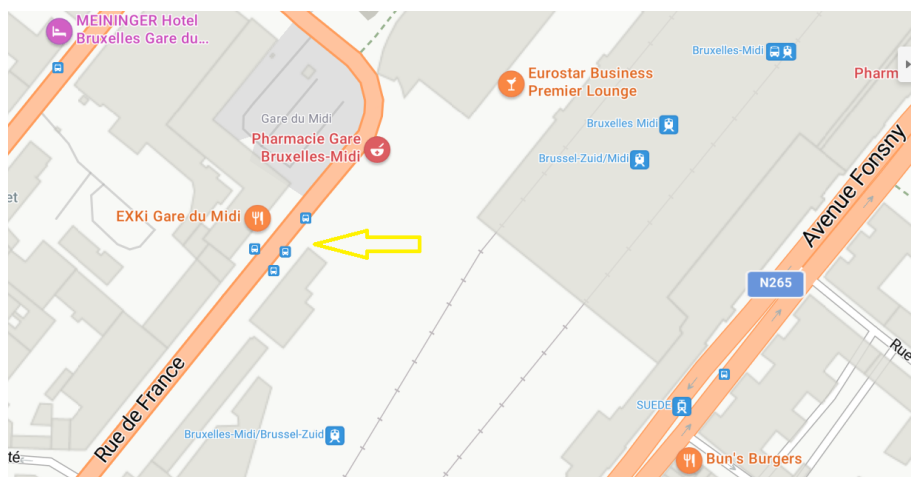

2) Public transport (by bus)

From South Station:

- Bus 78 (STIB/MIVB): direction Humaniteit/Humanité – stop at Internationalelaan/Boulevard international and then walk for 5-10 minutes

From metro station Ceria:

- Bus 98 (STIB/MIVB): stop at Bollinckx and walk for 5 minutes
- Busses 153, 154, 155 (De Lijn): stop at Bollinckx and then walk for 5 minutes

From metro Veeweide:

- Bus 810 (De Lijn): stop at Bollinckx and then walk for 5 minutes

3) Personal car

On Brussels Ring O, take exit 17 “Anderlecht”

50 m before the first traffic light, turn left.

At the end, turn left again, into Boulevard International.

Keep right and take the first entrance to the Riverside Business Park on your right (after the Total gas station). Take the roundabout and take first left, the second building to your left is Block J, Ansell Healthcare offices.

Parking arrangements

- **Ansell workers (employee, temp or contractor) cannot use visitor’s parking places**
- Park your car where you’ll find an Ansell parking plate or no company name mentioned
- Do not park your car on other companies parking places
- Respect entrances, evacuation and emergency exits
- Do not block any car when parking
- Mark your car using the Ansell’s parking sticker. This card can be obtained at the procurement & fleet department

How to get to our office?

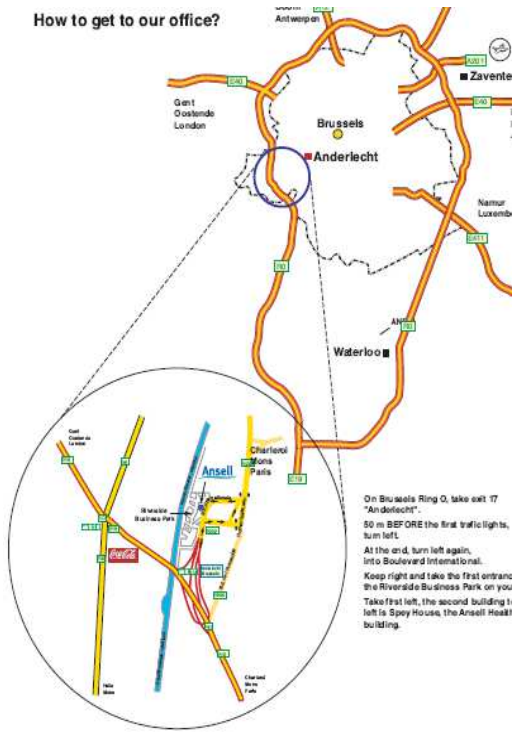

On Brussels Ring O, take exit 17 "Anderlecht".
50 m BEFORE the first traffic lights, turn left.
At the end, turn left again, into Boulevard International.
Keep right and take the first entrance the Riverside Business Park on you.
Take first left, the second building is left is Spicy House, the Ansell House building.

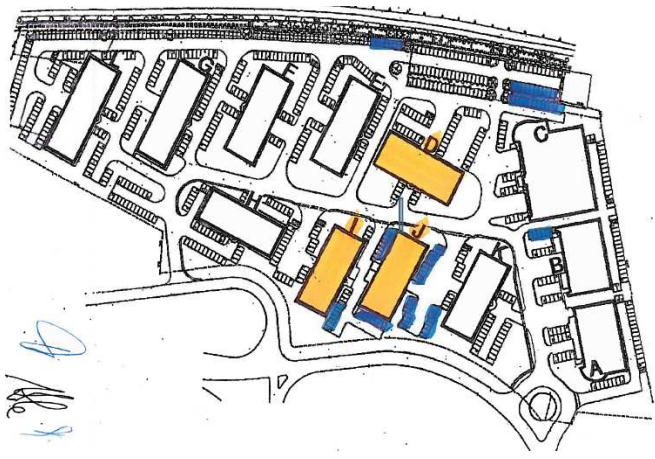

IN ORANGE: Ansell's buildings (I and J)
IN BLUE: Ansell's parking places,

4) Bike

Please find below some routes to use when cycling to work: <https://www.anderlecht.be/nl/met-de-fiets>

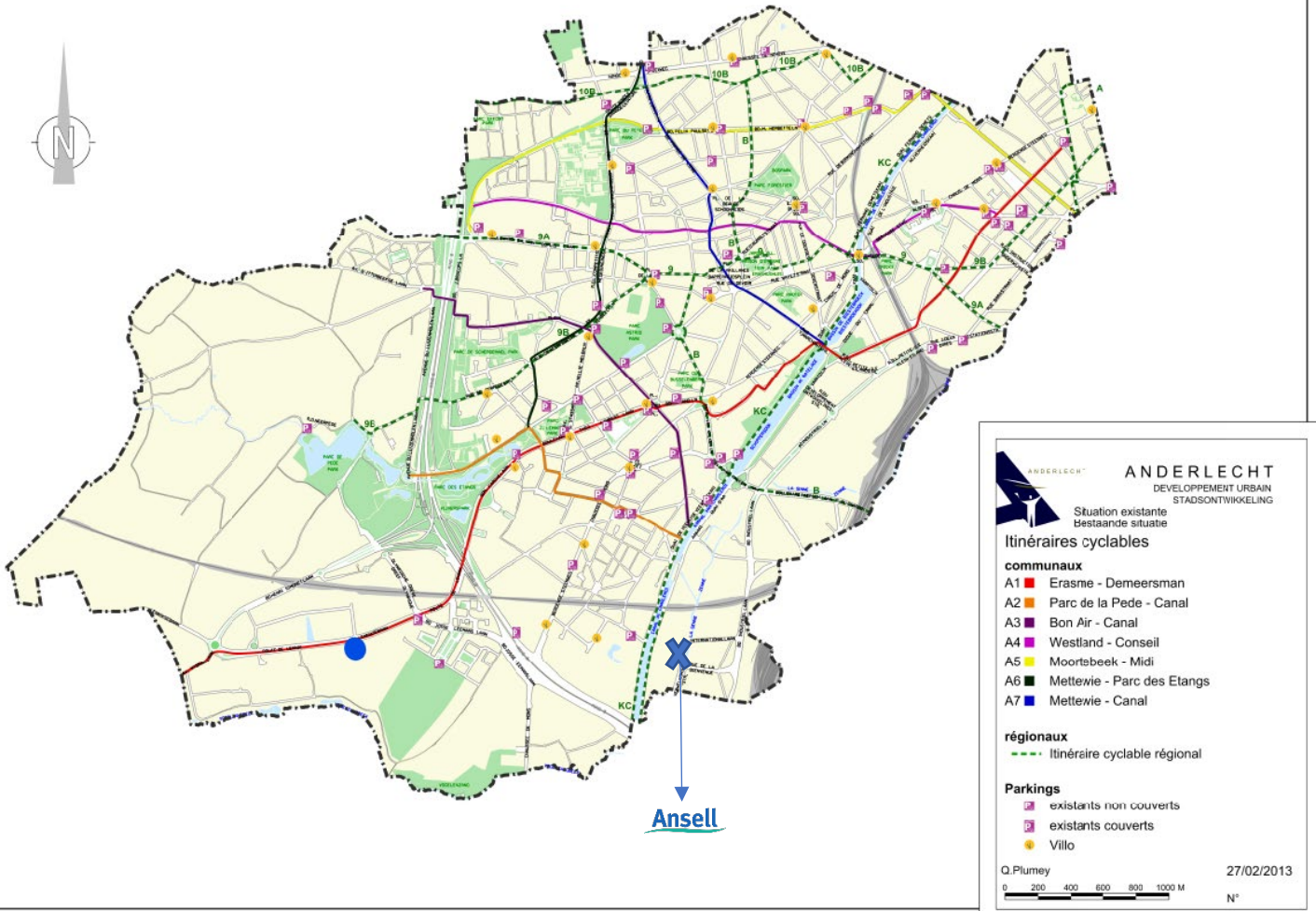

Want to make your journey even more enjoyable?



There are plenty of nice biking routes available in both Flanders, Brussels region and Wallonie via:

<https://www.komoot.com/>

<https://fietsnelwegen.be/>



Where to park your bike when arriving at the office?

			
Aanvulling gegevens grondplan aankomende investeerder			
Grondplan GELINKLOERS Schaarweg 100B 3825 ST37		Eigendom: GELINKLOERS	
Plan: GP1		